

ARWIS TERRA COTTA CEPHE SİSTEMİ

AC 70

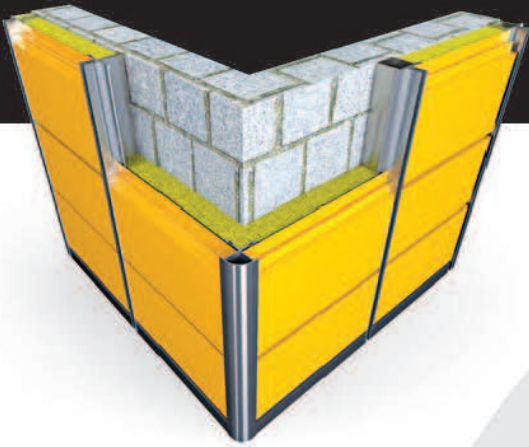



SİSTEM NUMARASI

70 AC 644

70 AC 645

70 AC 646

KALIP NUMARASI

644

645

646

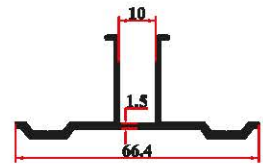
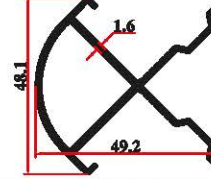
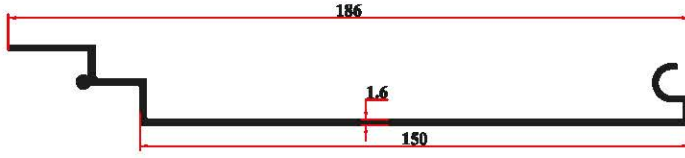
**AĞIRLIK:0,988 kg/mt****0,705 kg/mt****0,505 kg/mt**jx:124,406 cm⁴jx:4,06 cm⁴jx:5,001 cm⁴jy:1,246 cm⁴jy:5,86 cm⁴jy:1,288 cm⁴

Lambiri Profili(150 mm)

Köşe Bağlantı

Kasa Bağlantı

SİSTEM NUMARASI

70 AC 647

70 AC 648

70 AC 691

70 AC 511

KALIP NUMARASI

647

648

691

511

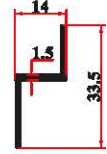
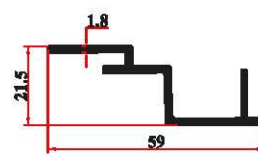
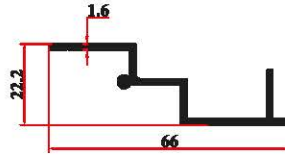
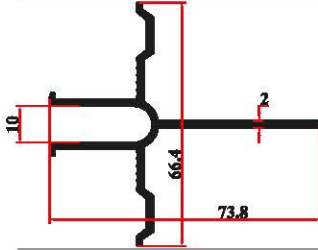
**AĞIRLIK:0,802 kg/mt****0,454 kg/mt****0,462 kg/mt****0,165 kg/mt**jx:9,097 cm⁴jy:4,860 cm⁴

Çelik Bağlantı Ankrajı

Alt Bitim Tiji

Alt Bitim Tiji

Üst Bitim Tiji

SİSTEM NUMARASI

70 AC 649

70 AC 692

KALIP NUMARASI

649

692

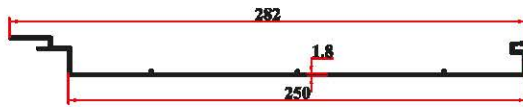

ÖLÇEK: 1/4

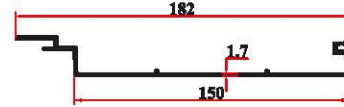

ÖLÇEK: 1/4

AĞIRLIK:1,660 kg/mtjx:466,906 cm⁴jy:2,244 cm⁴

Orta Kenet Profili (250 mm)

AĞIRLIK:1,096 kg/mtjx:139,717 cm⁴jy:1,880 cm⁴

Orta Kenet Profili (150 mm)

AKSESUAR KODU

AKSESUAR RESMİ

KULLANILDIĞI YER

AKSESUAR KODU

AKSESUAR RESMİ

KULLANILDIĞI YER

70 AC F30
İç Cam Fihli
USN 30

1 Koliye 10 kg/179 m

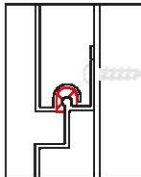
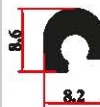
70 AC F48
İç Cam Fihli
USN 48

1 Koliye 12 kg/660 m

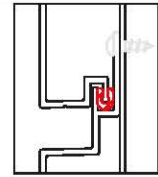

Dikkat: Sistemde ara dikmeler arasındaki mesafe 2,5 metreyi geçmemelidir.

Attention: In the system, the distance between the intermediate struts should not exceed 2.5 meters.

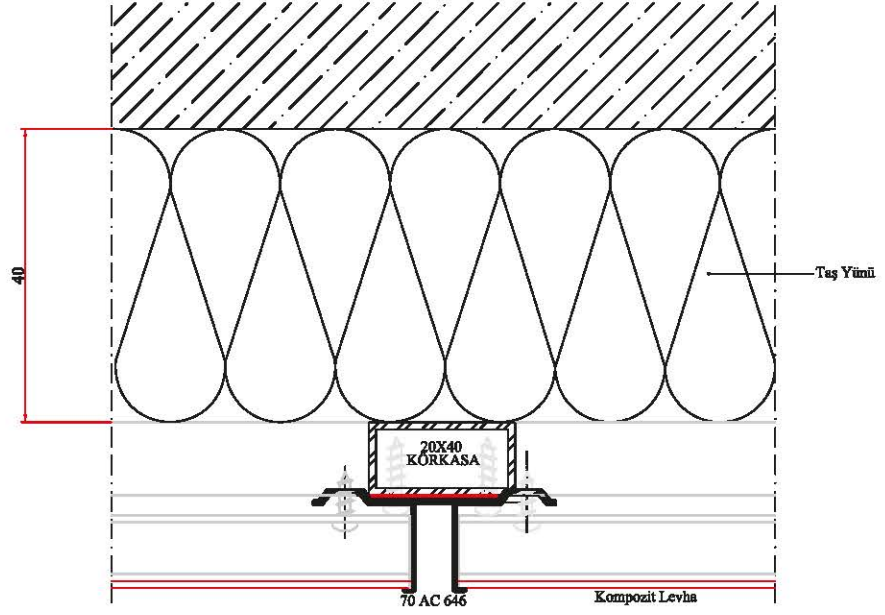
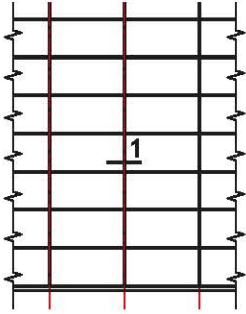

1 NOLU DETAY

ÖLÇEK:1/2

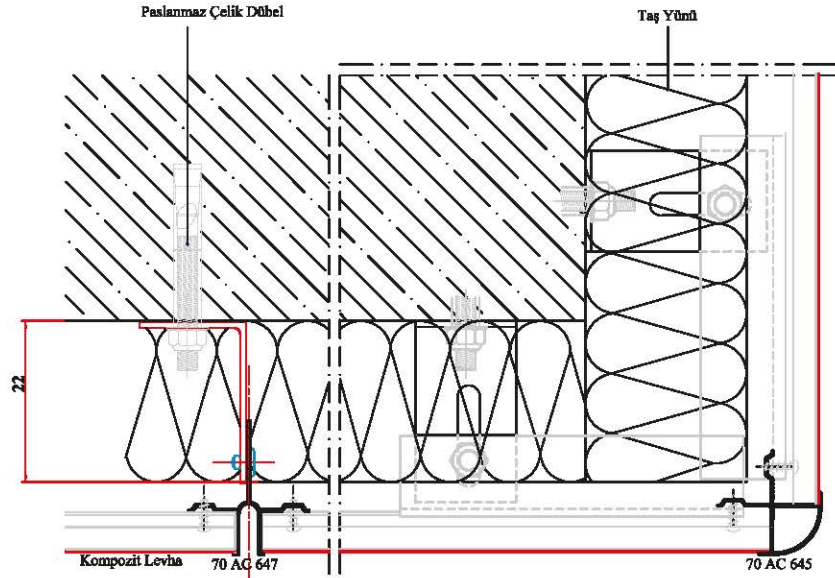
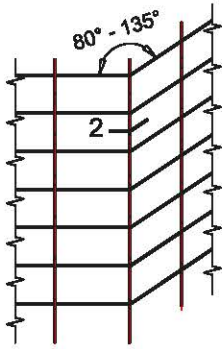

2 NOLU DETAY

Dikkat: Sistem taşıyıcı hesabı statiker tarafından yaptırılmalıdır.
Attention: The system support should be calculated by the structural engineer.

ÖLÇEK:1/4

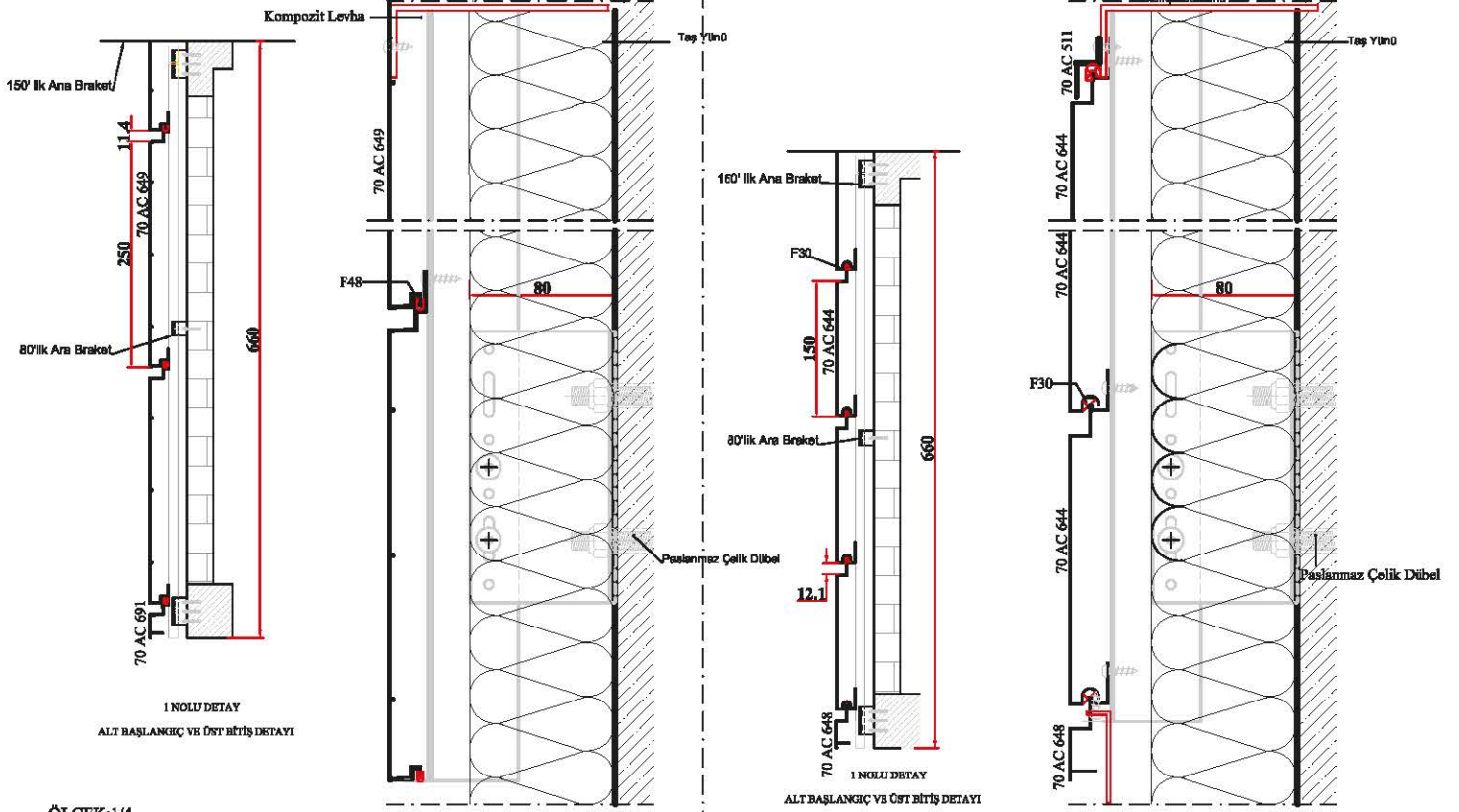
SİSTEM DETAYLARI / SYSTEM DETAILS

ÖLÇEK:1/4

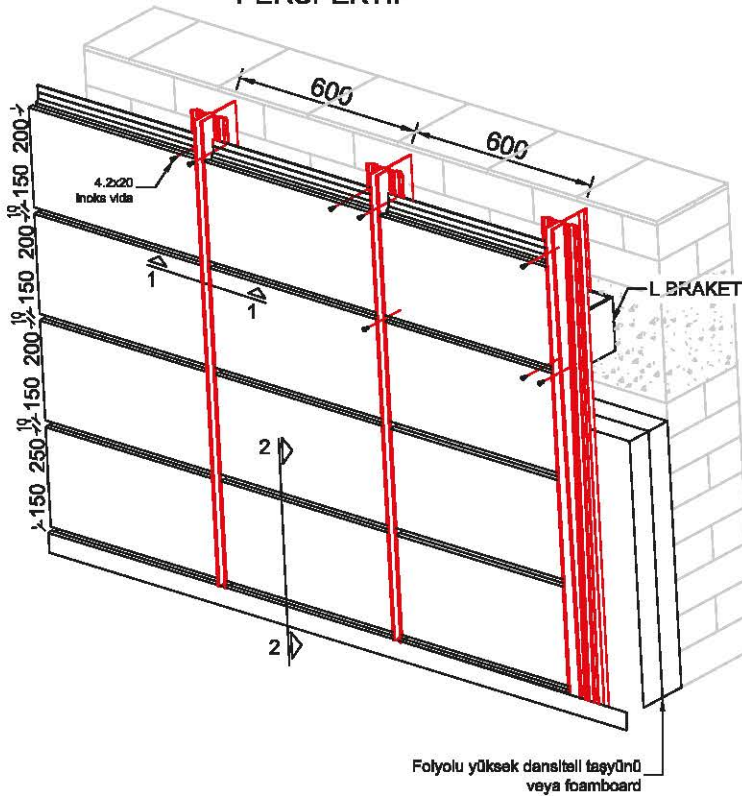
SİSTEM DETAYLARI / SYSTEM DETAILS
PERSPEKTİF

ÖLÇEK:1/4

2 NOLU DETAY